

DETAIL DRAWINGS

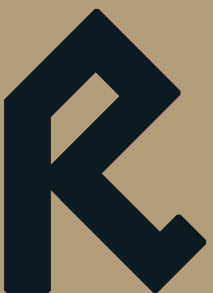

RIVERCLACK

SHAPING ROOFS

DETAIL DRAWINGS

DETAIL DRAWINGS GENERAL NOTES

The technical data provided in this communication is for information purposes only.

The following detail drawings represent suggestions for standard roof structure design and must be adapted by the addressee according to actual construction conditions.

The design of these types of roof structure requires careful planning and calculation based on the actual conditions.

The choice and use of proper fixed points and screws must be made in accordance with the static calculations.

ISCOM SPA provides this information based on its experience and knowledge and accepts no liability for any loss, damage, costs or expense incurred in relation to or arising from any person relying on the suggestions and information rendered.

All information issued by ISCOM SPA is subject to continuous development without notification. The information/details contained in this communication are correct at the date of issue. It is the addressee's responsibility to ascertain from ISCOM SPA that the information contained in this communication has not changed at the time of use by the addressee.

DUO PITCH RIDGE	05
MONO PITCH RIDGE	13
VERGE DETAILS	21
EAVES DETAILS	27
EXPANSION JOINTS	37
ROOF PENETRATIONS	41
SKYLIGHTS	43
OVERLAP DETAILS	51
CURVED ROOF RIDGE	55

DUO PITCH RIDGE
STEEL STRUCTURE

DETAIL 01.01.S

TECHNICAL SITUATION / SCALE 1:5

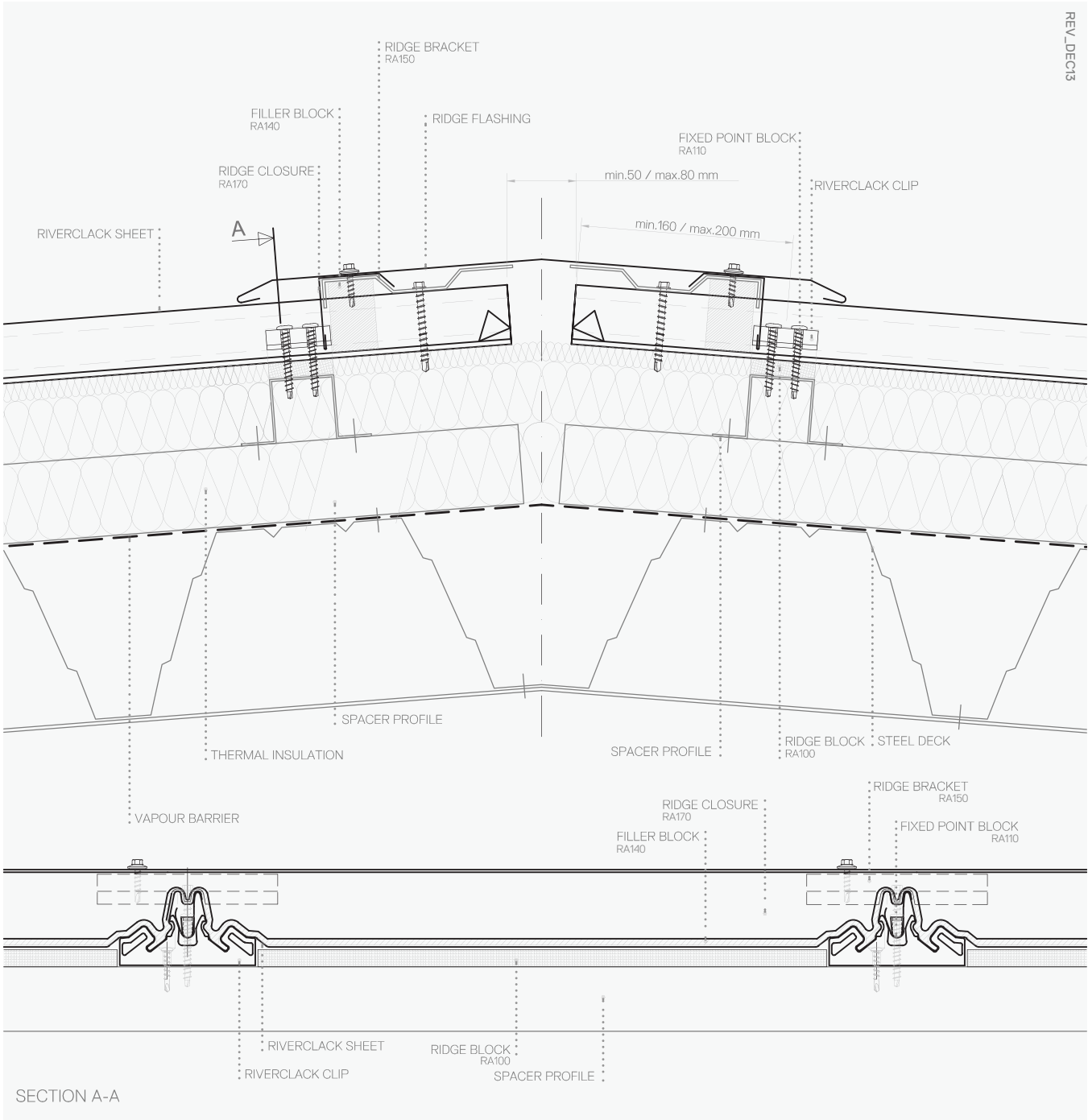

NOTES

- Slope > 6%
- If length of sheet > 20m use item RA120 as fixed point according to instructions or use two RA110 (up to max length 40m) according to instructions

For further enquiries please contact Iscom's technical department or your local representative.

WWW.RIVERCLACK.COM

DUO PITCH RIDGE
STEEL STRUCTURE

DETAIL 01.02.S

TECHNICAL SITUATION / SCALE 1:5

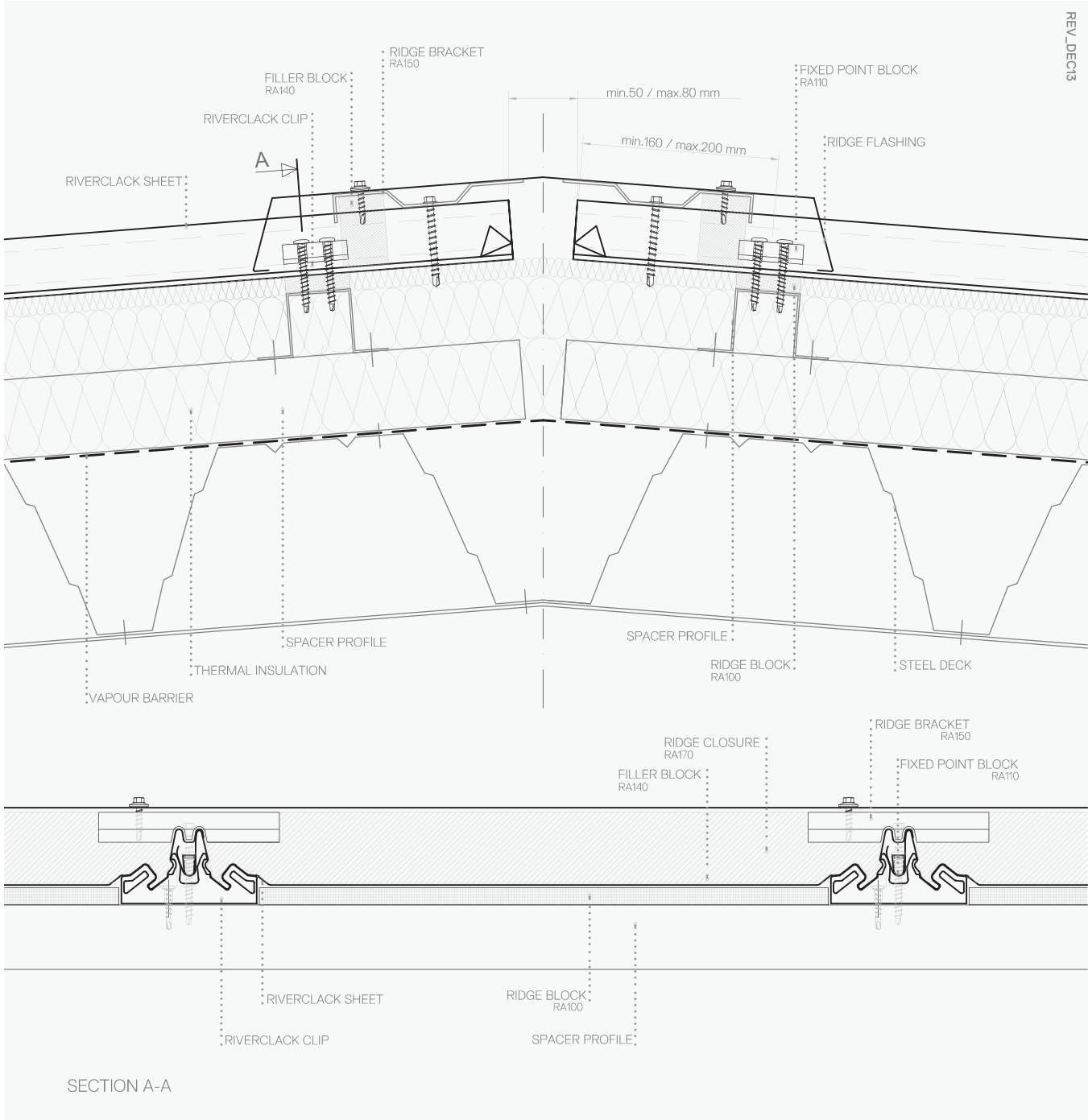

NOTES

- Slope > 6%
- If length of sheet > 20m use item RA120 as fixed point according to instructions or use two RA110 (up to max length 40m) according to instructions

For further enquiries please contact Iscom's technical department or your local representative.

WWW.RIVERCLACK.COM

DUO PITCH RIDGE

STEEL STRUCTURE

DETAIL 01.03.S

TECHNICAL SITUATION / SCALE 1:5

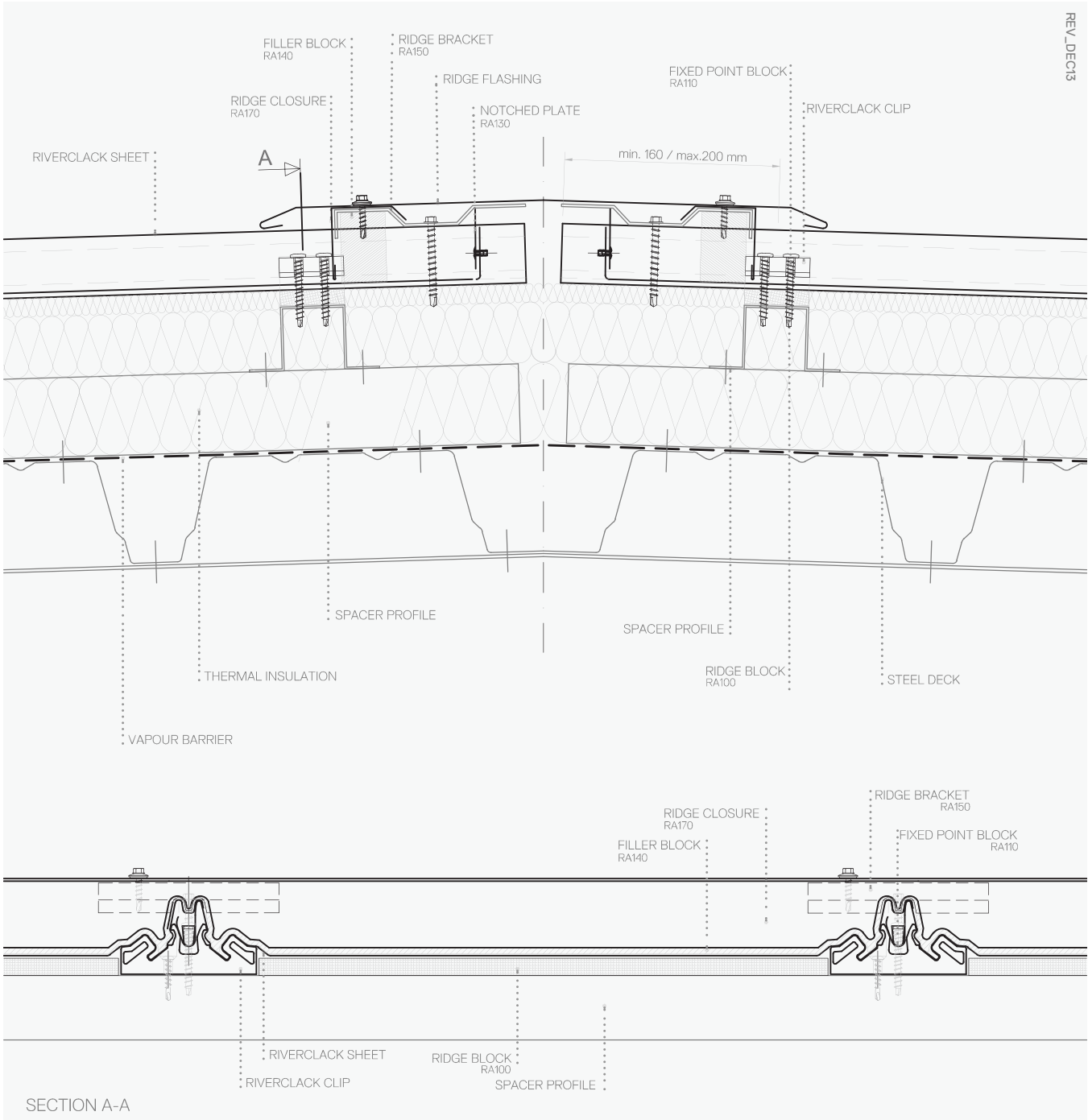

NOTES

- Slope < 6%
- If length of sheet > 20m use item RA120 as fixed point according to instructions or use two RA110 (up to max length 40m) according to instructions

For further enquiries please contact Iscom's technical department or your local representative.

WWW.RIVERCLACK.COM

DUO PITCH RIDGE

STEEL STRUCTURE

DETAIL 01.04.S

TECHNICAL SITUATION / SCALE 1:5

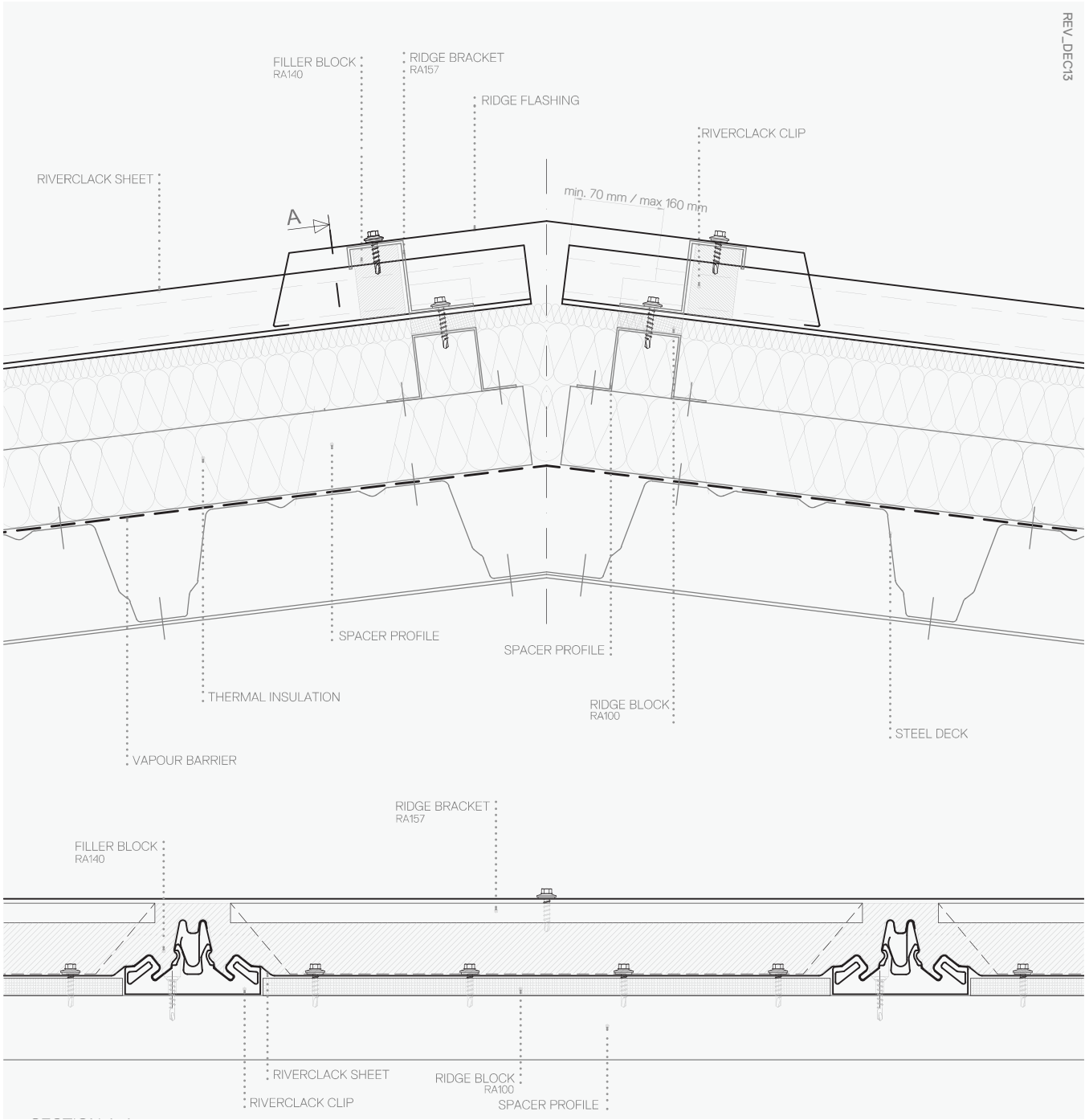

- NOTES
- Slope > 6%
 - As ridge bracket RA150 is also a fixed point use it according to instructions

For further enquiries please contact Iscom's technical department or your local representative.

WWW.RIVERCLACK.COM

MONO PITCH RIDGE

STEEL STRUCTURE

DETAIL 02.01.S

TECHNICAL SITUATION / SCALE 1:5

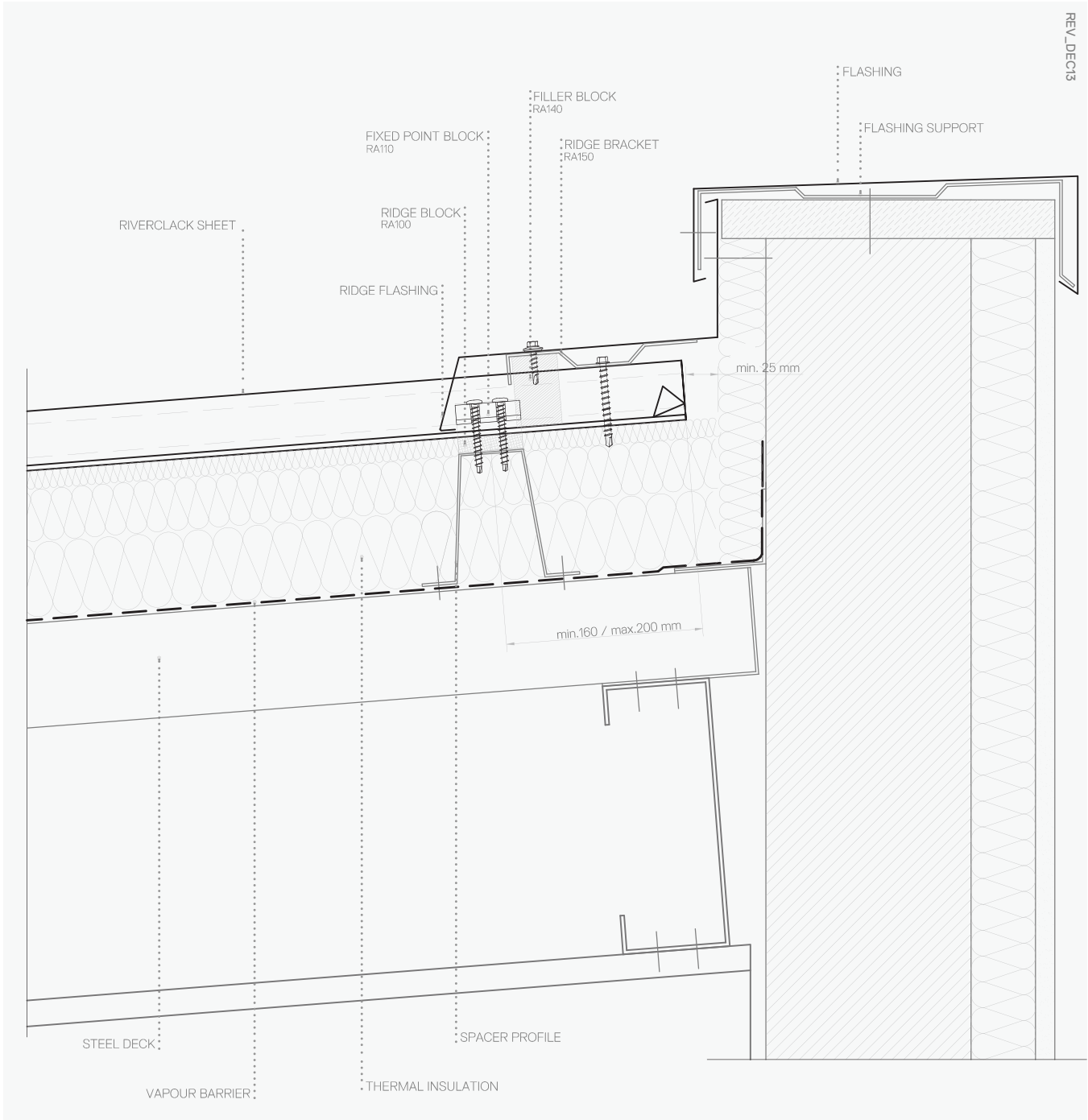

NOTES

- Slope > 6%
- If length of sheet > 20m use item RA120 as fixed point according to instructions or use two RA110 (up to max length 40m) according to instructions

For further enquiries please contact Iscom's technical department or your local representative.

WWW.RIVERCLACK.COM

MONO PITCH RIDGE
STEEL STRUCTURE

DETAIL 02.02.S

TECHNICAL SITUATION / SCALE 1:5

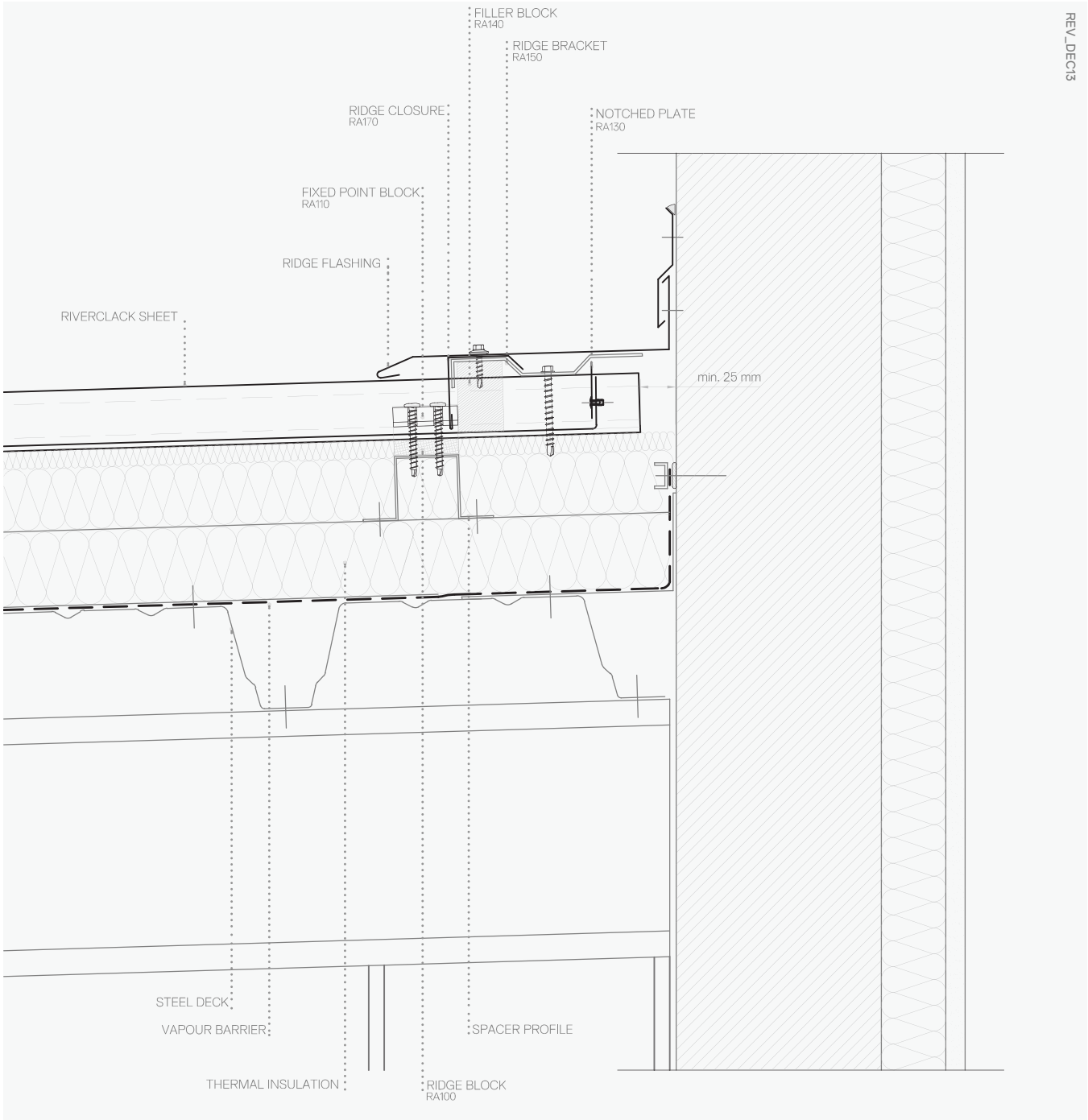

NOTES
- Slope < 6%
- If length of sheet > 20m use item RA120 as fixed point according to instructions or use two RA110 (up to max length 40m) according to instructions

For further enquiries please contact Iscom's technical department or your local representative.
WWW.RIVERCLACK.COM

MONO PITCH RIDGE

STEEL STRUCTURE

DETAIL 02.03.S

TECHNICAL SITUATION / SCALE 1:5

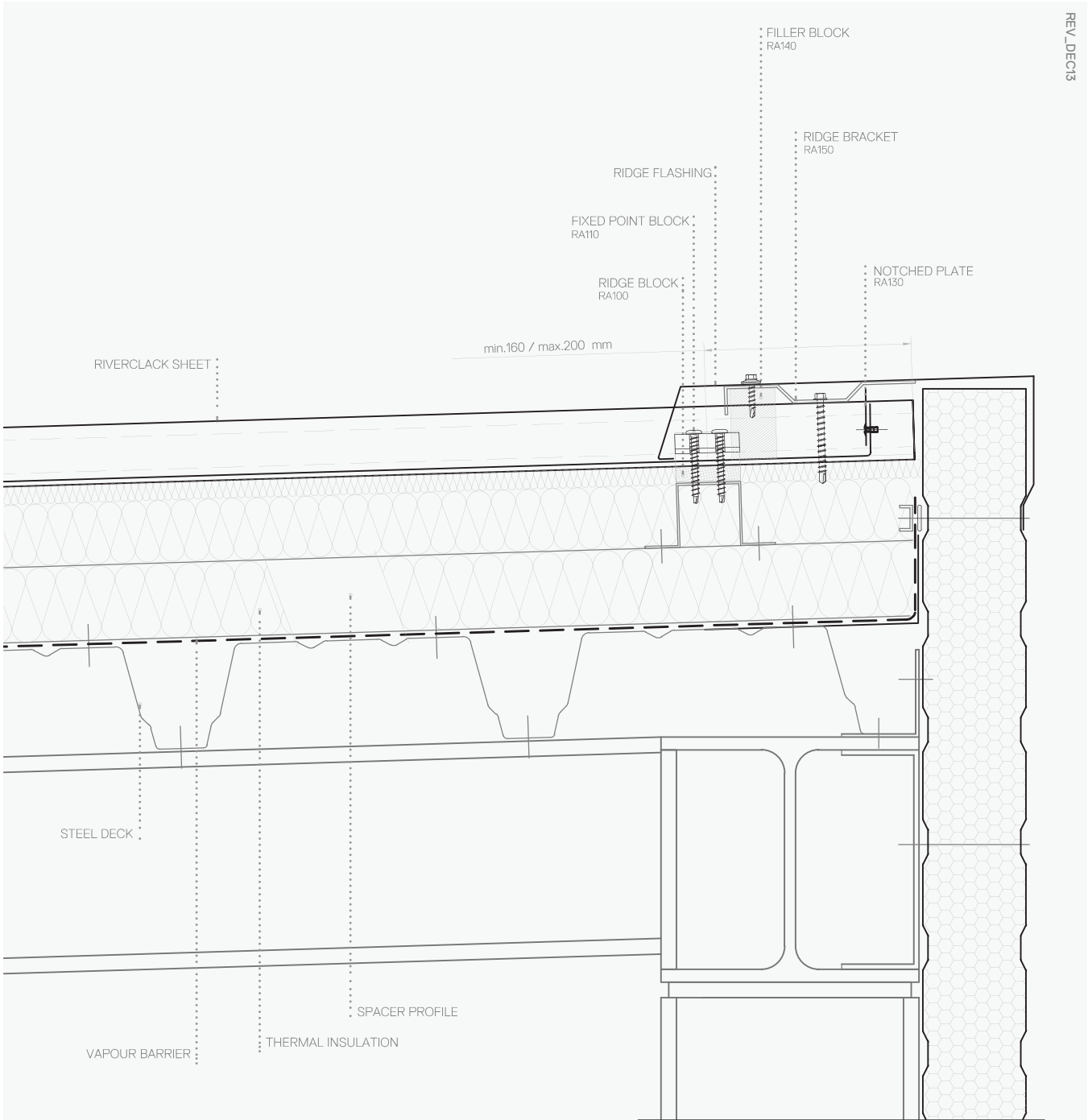

- NOTES
- Slope < 6%
 - If length of sheet > 20m use item RA120 as fixed point according to instructions or use two RA110 (up to max length 40m) according to instructions

For further enquiries please contact Iscom's technical department or your local representative.

WWW.RIVERCLACK.COM

MONO PITCH RIDGE

STEEL STRUCTURE

DETAIL 02.04.S

TECHNICAL SITUATION / SCALE 1:5

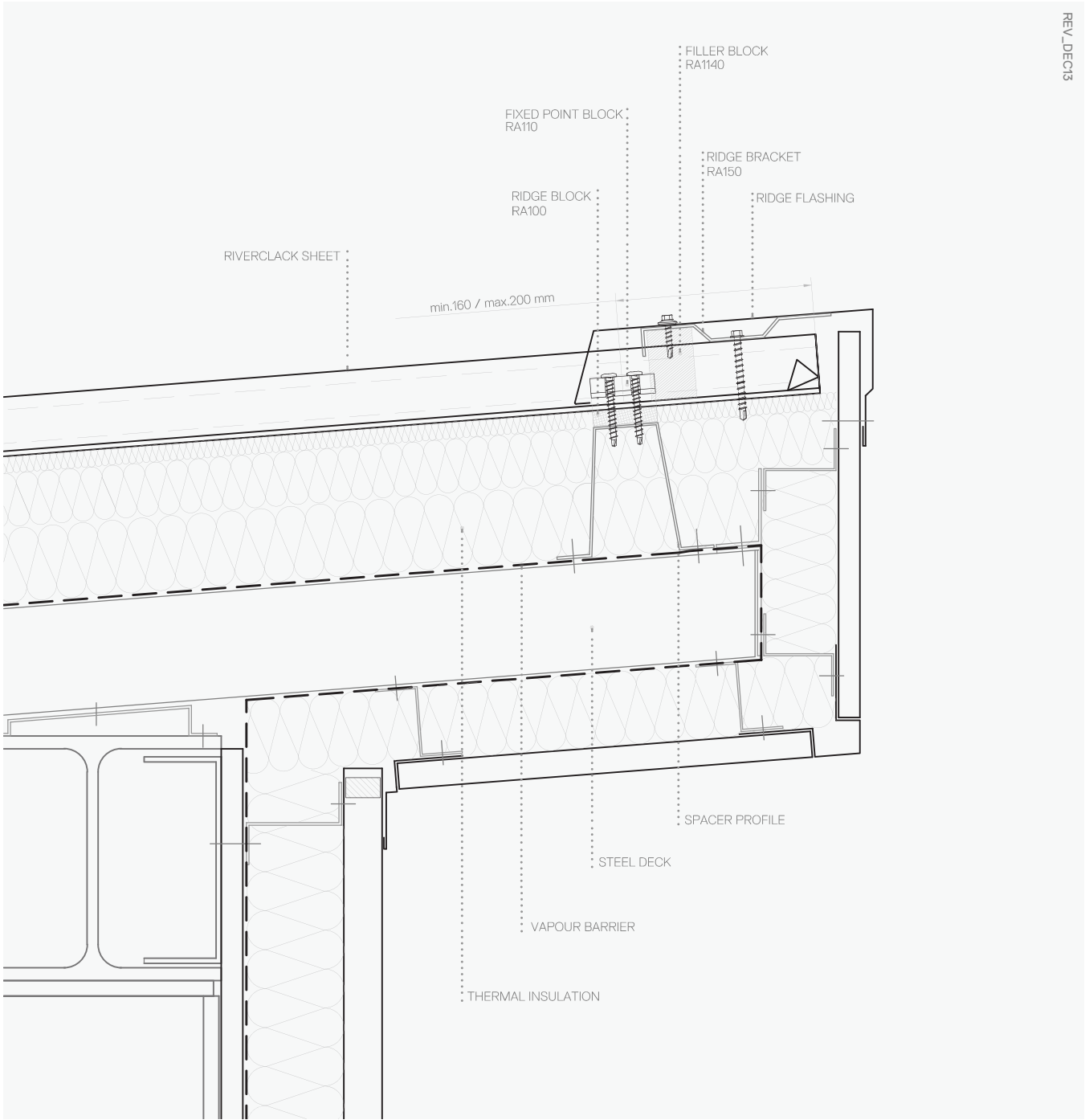

NOTES
- Slope > 6%
- If length of sheet > 20m use item RA120 as fixed point according to instructions or use two RA110 (up to max length 40m) according to instructions

For further enquiries please contact Iscom's technical department or your local representative.
WWW.RIVERCLACK.COM

PARAPET VERGE
STEEL STRUCTURE

DETAIL 03.01.S

TECHNICAL SITUATION / SCALE 1:5

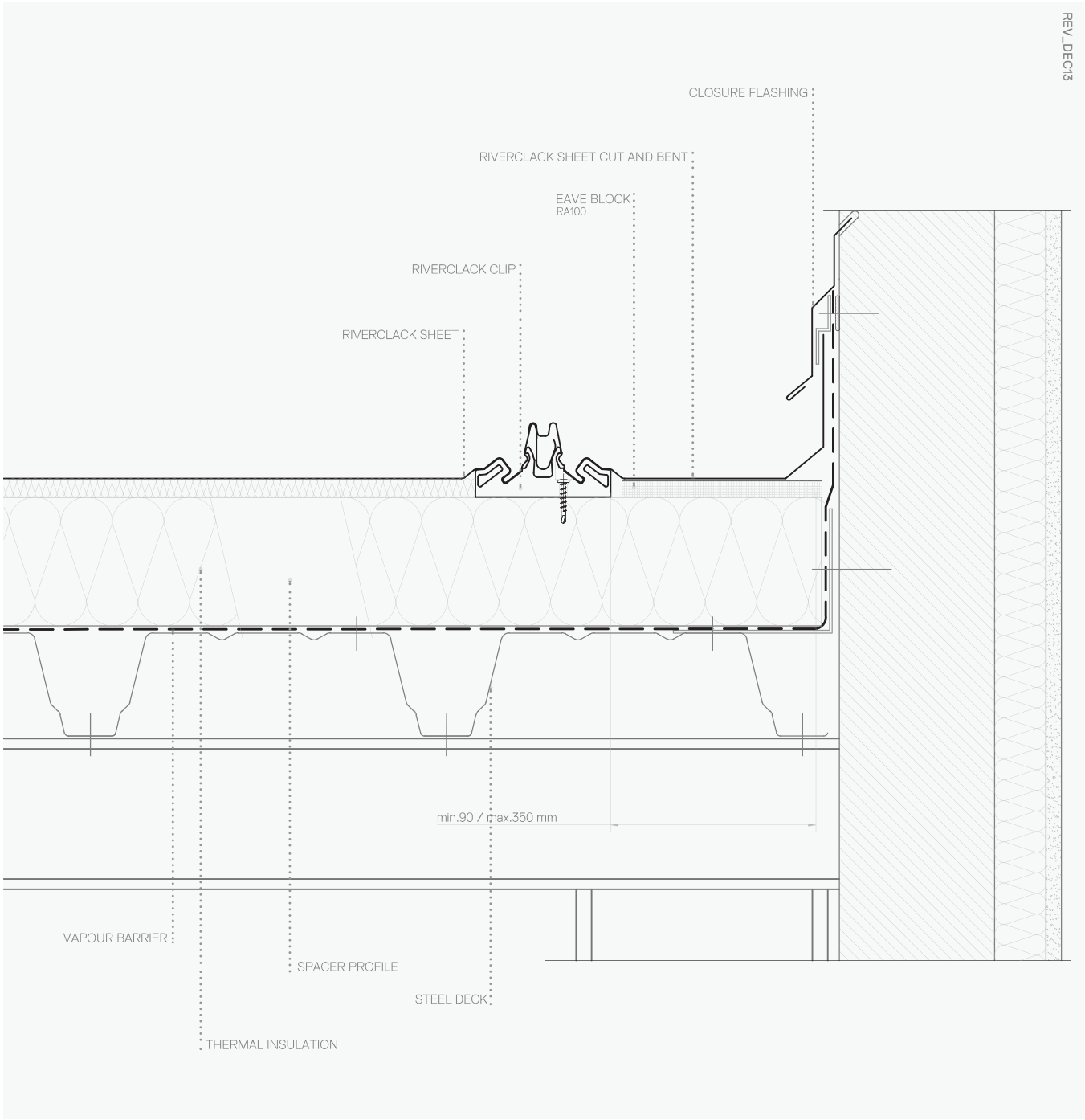

NOTES

For further enquiries please contact Iscom's technical department or your local representative.

WWW.RIVERCLACK.COM

PARAPET VERGE
STEEL STRUCTURE

DETAIL 03.02.S

TECHNICAL SITUATION / SCALE 1:5

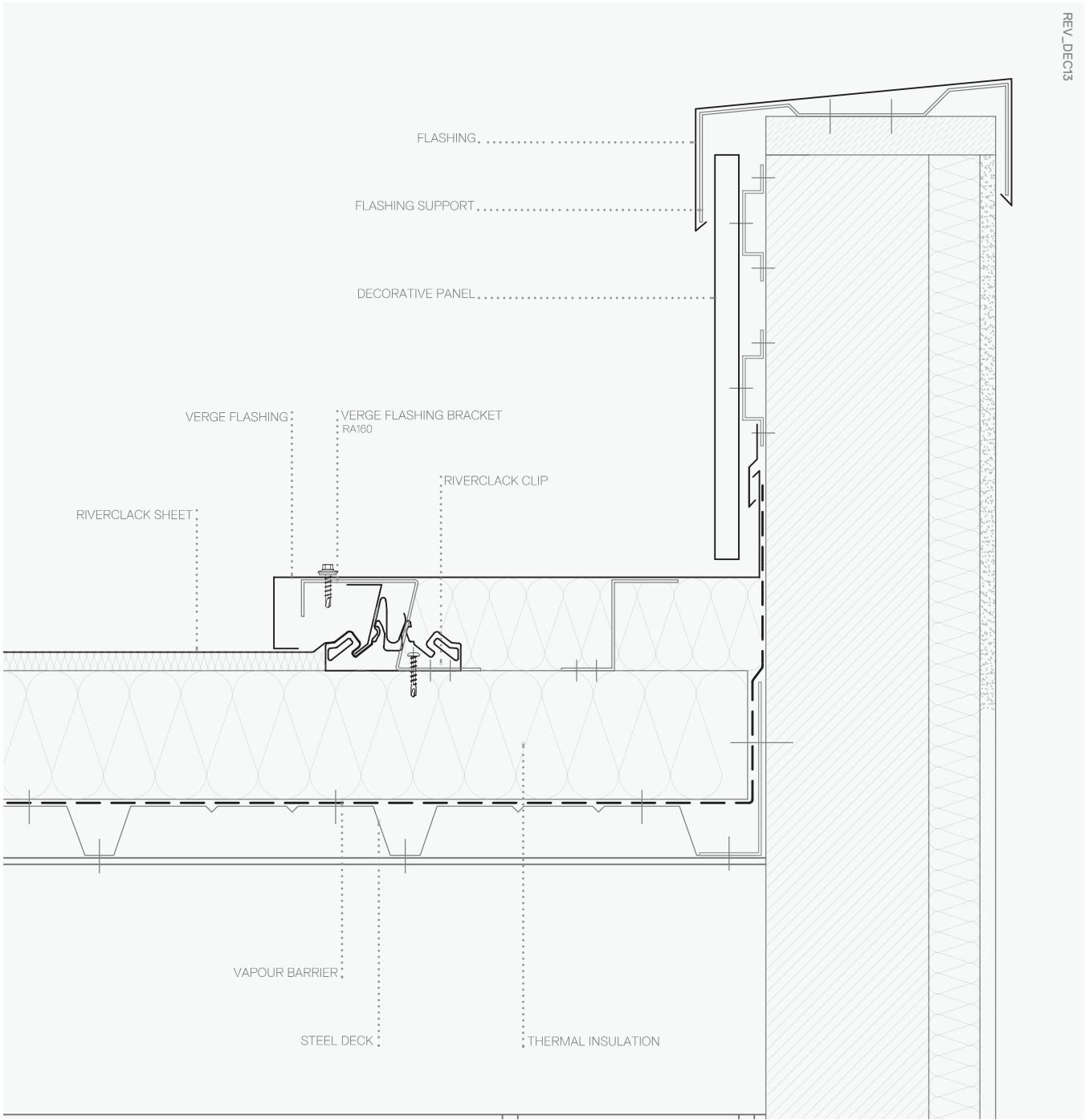

NOTES

For further enquiries please contact Iscom's technical department or your local representative.

WWW.RIVERCLACK.COM

OVERHANGING VERGE

STEEL STRUCTURE

DETAIL 03.03.S

TECHNICAL SITUATION / SCALE 1:5

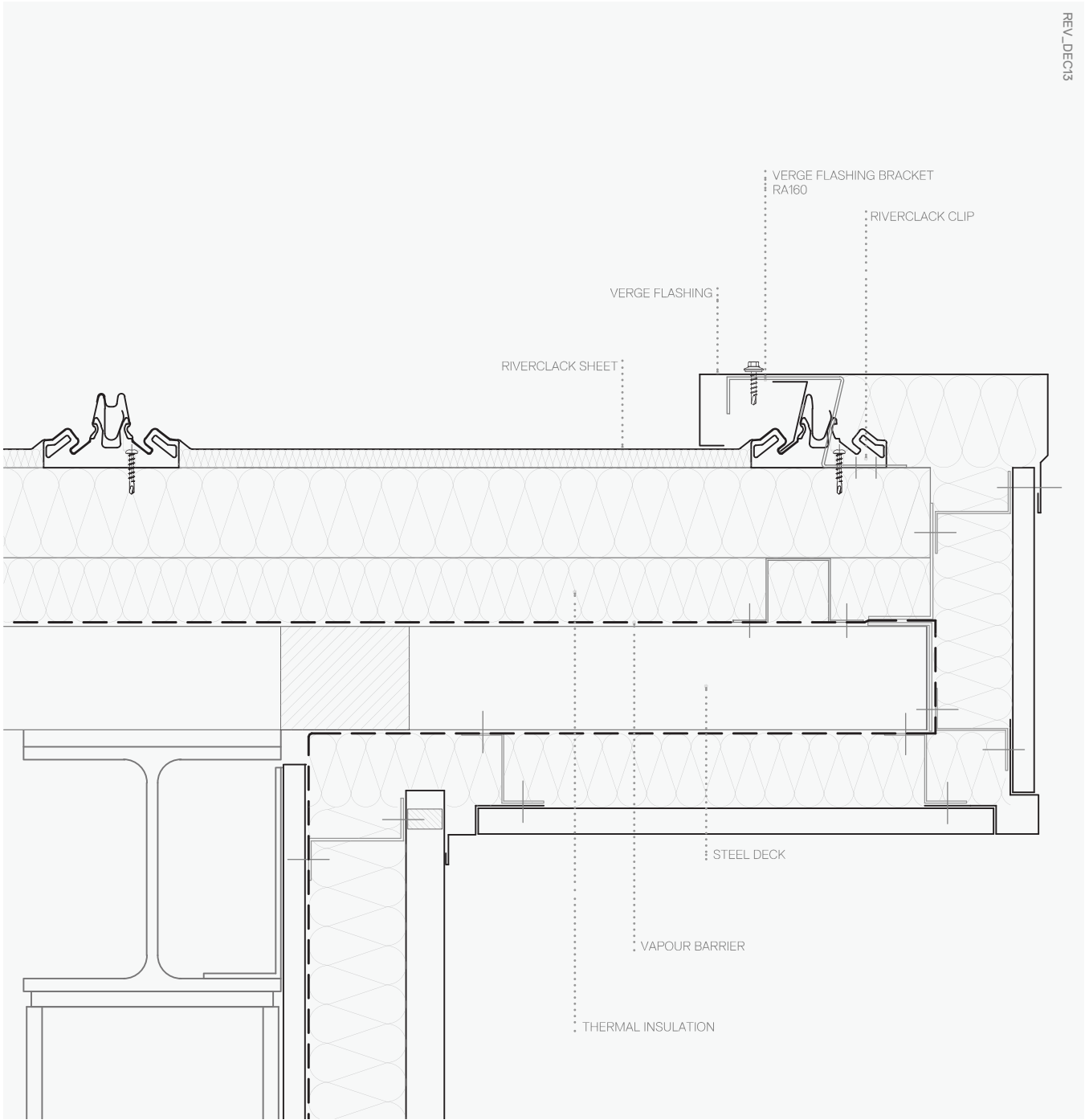

NOTES

For further enquiries please contact Iscom's technical department or your local representative.

WWW.RIVERCLACK.COM

EAVES GUTTER
STEEL STRUCTURE

DETAIL 04.01.S

TECHNICAL SITUATION / SCALE 1:5

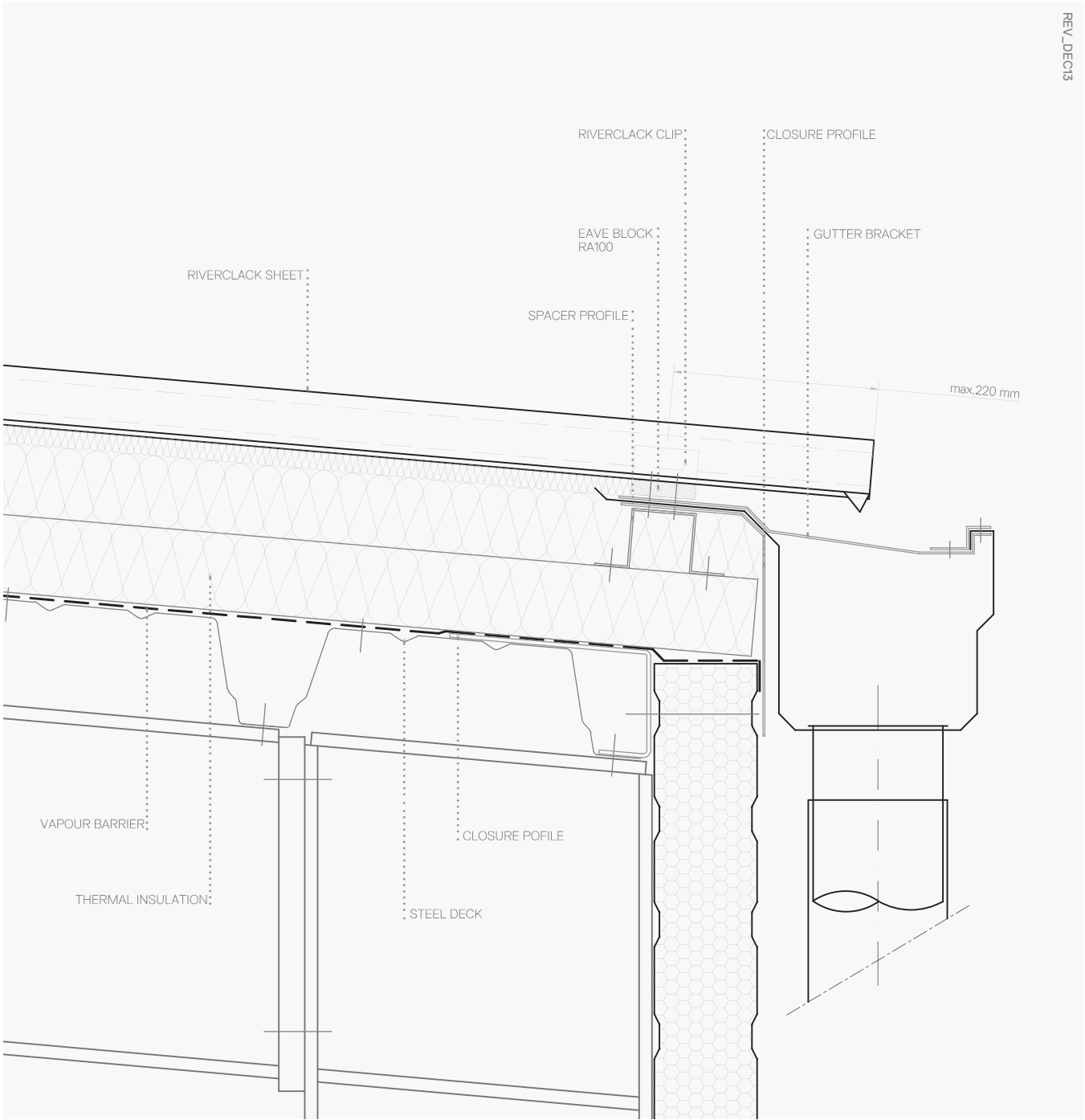

REV_DEC13

NOTES

For further enquiries please contact Iscom's technical department or your local representative.

WWW.RIVERCLACK.COM

PARAPET EAVES GUTTER

STEEL STRUCTURE

DETAIL 04.02.S

TECHNICAL SITUATION / SCALE 1:5

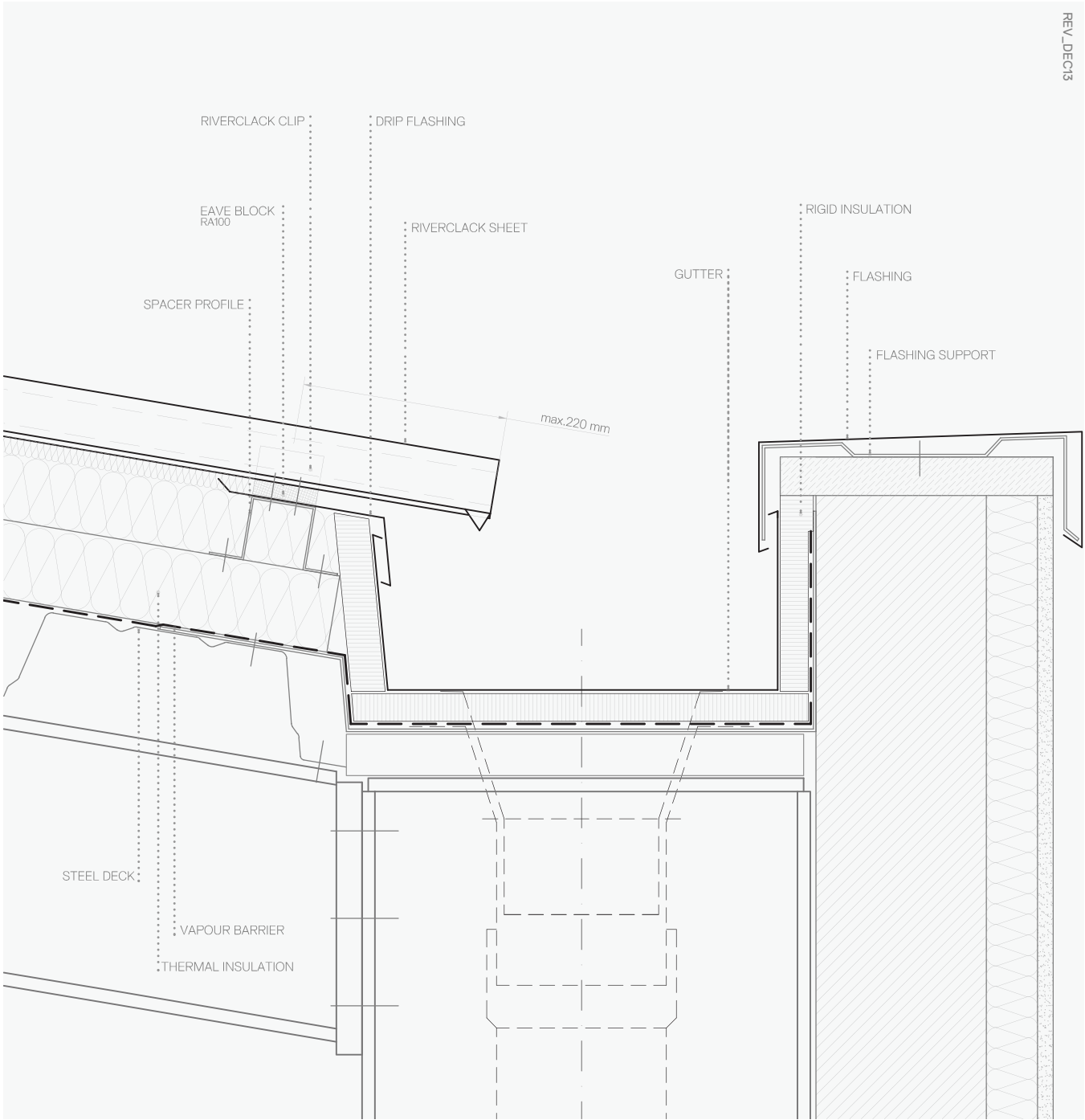

NOTES

For further enquiries please contact Iscom's technical department or your local representative.

WWW.RIVERCLACK.COM

VALLEY GUTTER
STEEL STRUCTURE

DETAIL 04.03.S

TECHNICAL SITUATION / SCALE 1:5

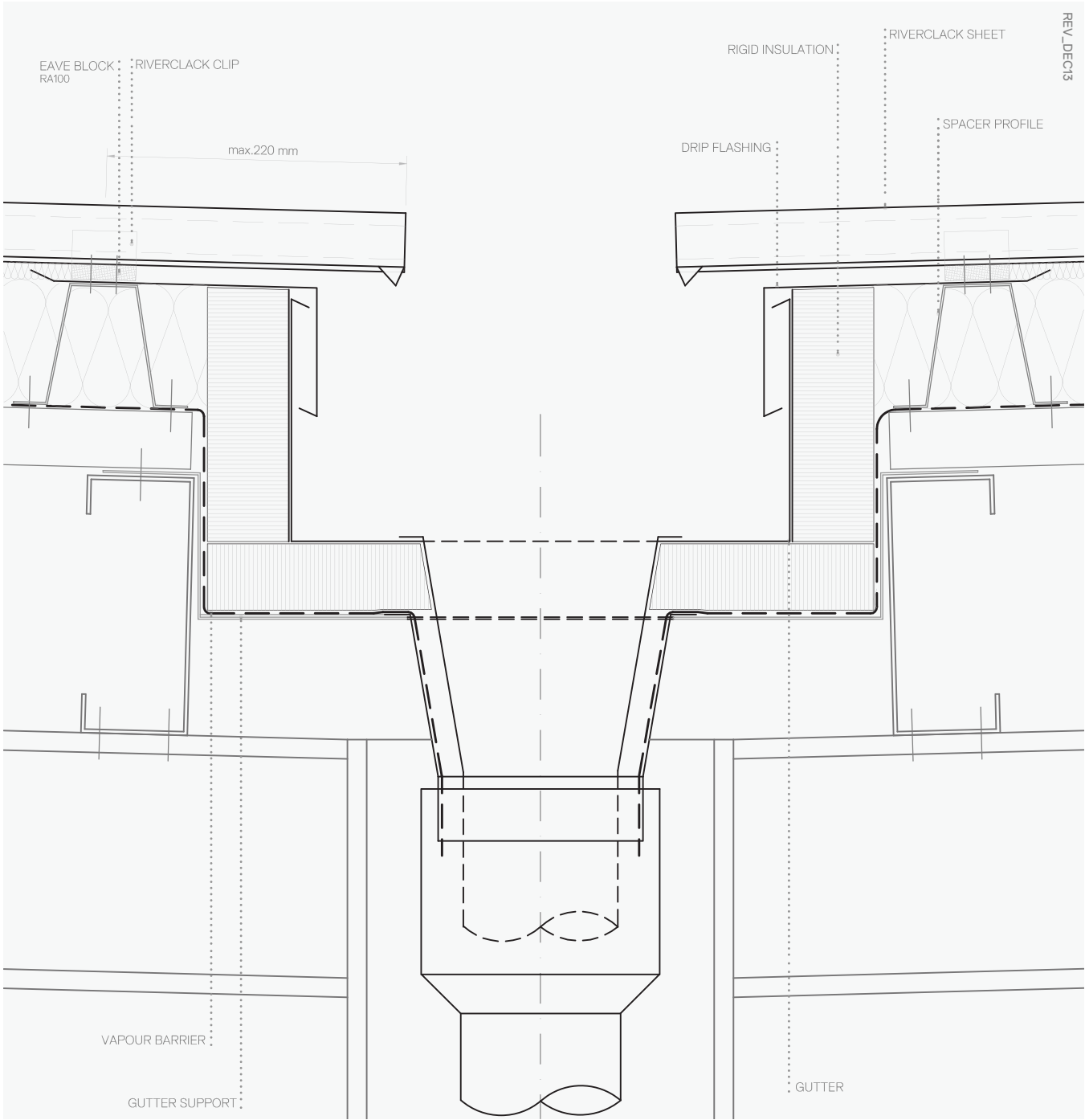

NOTES

For further enquiries please contact Iscom's technical department or your local representative.

WWW.RIVERCLACK.COM

INTERMEDIATE GUTTER

DETAIL 04.04.S

TECHNICAL SITUATION / SCALE 1:5

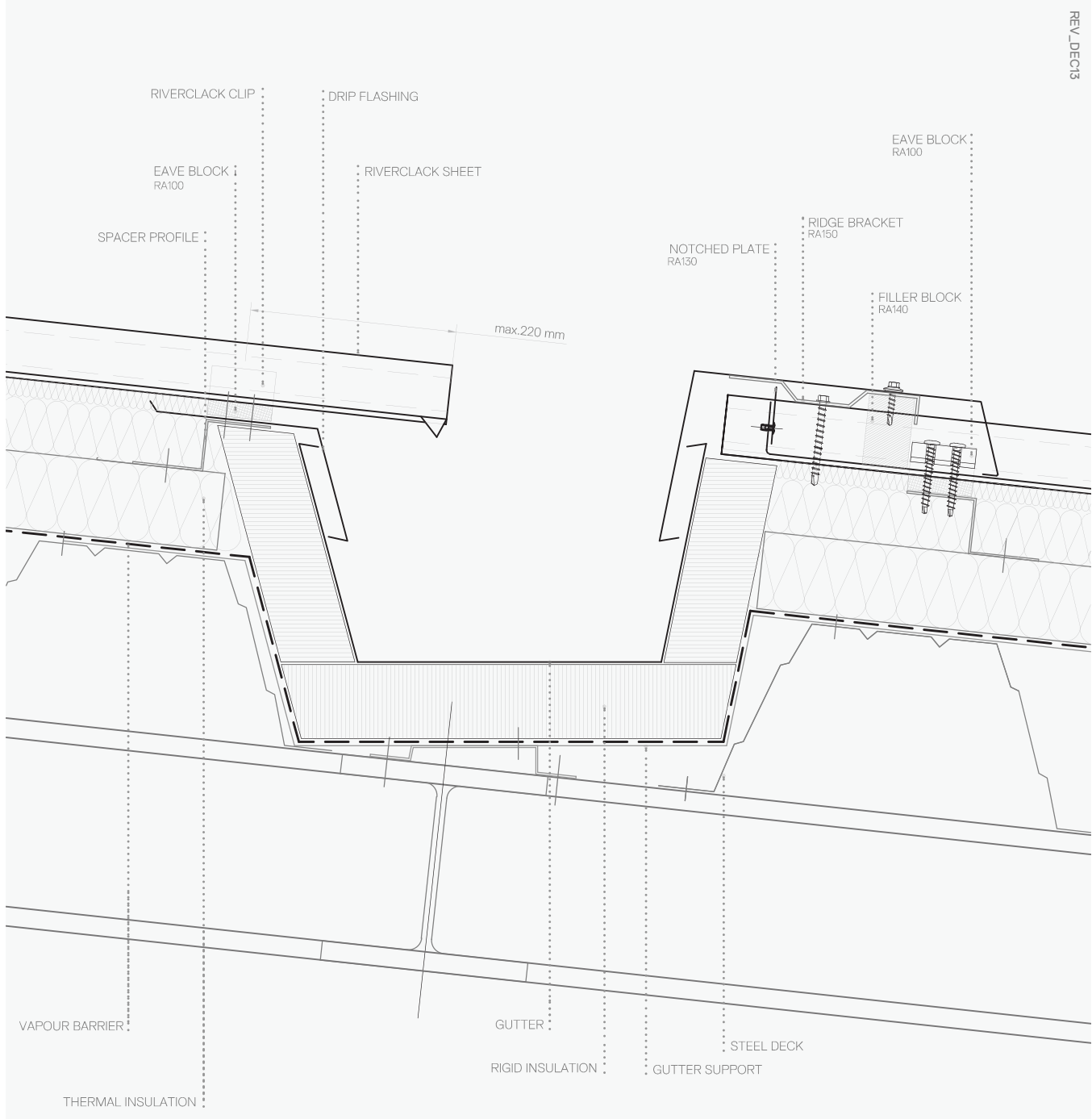

NOTES

- Mono ridge type considered on this sheet is one of the available options. Please consider proper type according to actual slope.

WWW.RIVERCLACK.COM

TECHNICAL SITUATION / SCALE 1:10

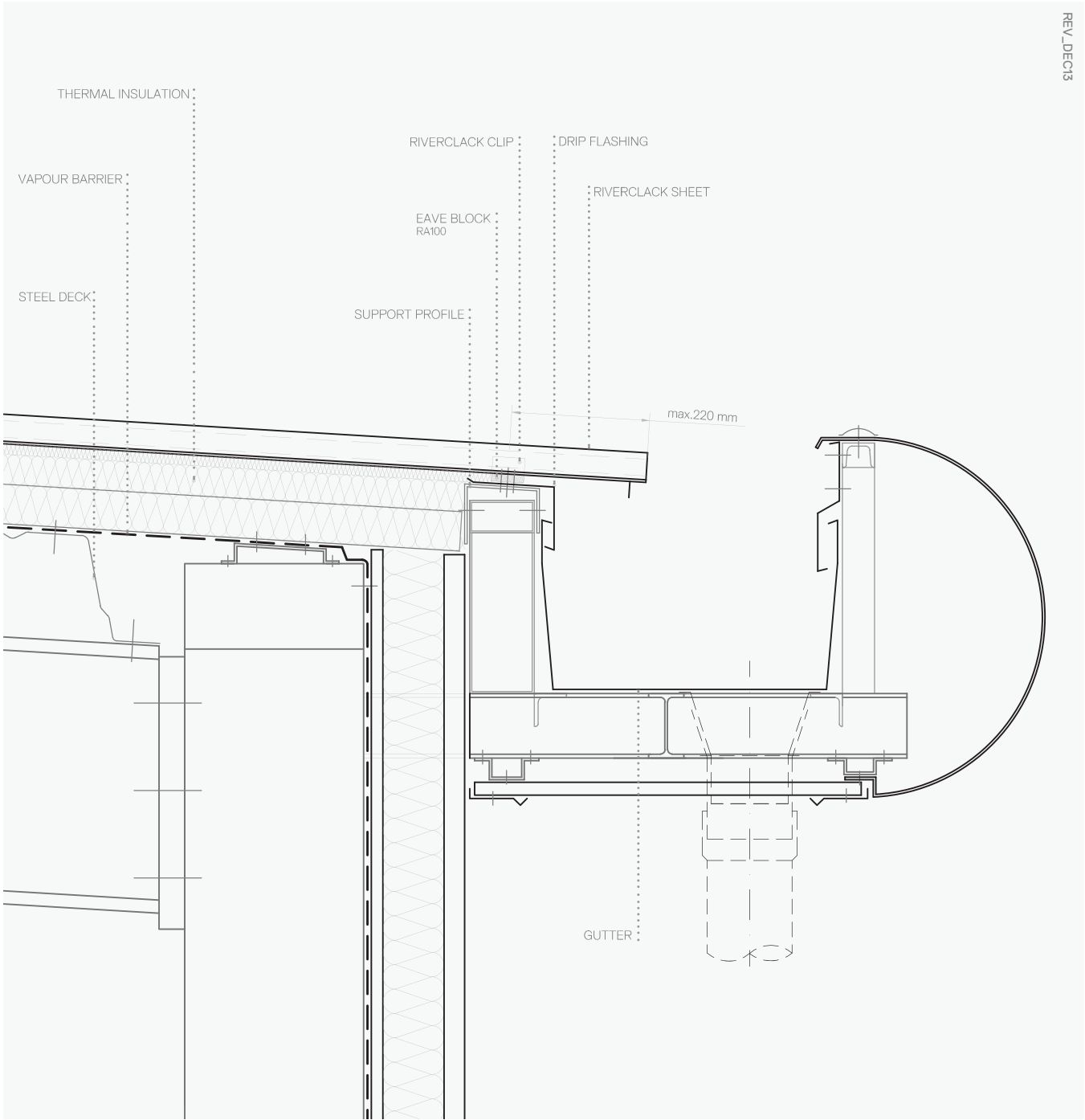

NOTES

For further enquiries please contact Iscom's technical department or your local representative.

WWW.RIVERCLACK.COM

EXPANSION JOINT
STEEL STRUCTURE

DETAIL 05.01.S

TECHNICAL SITUATION / SCALE 1:5

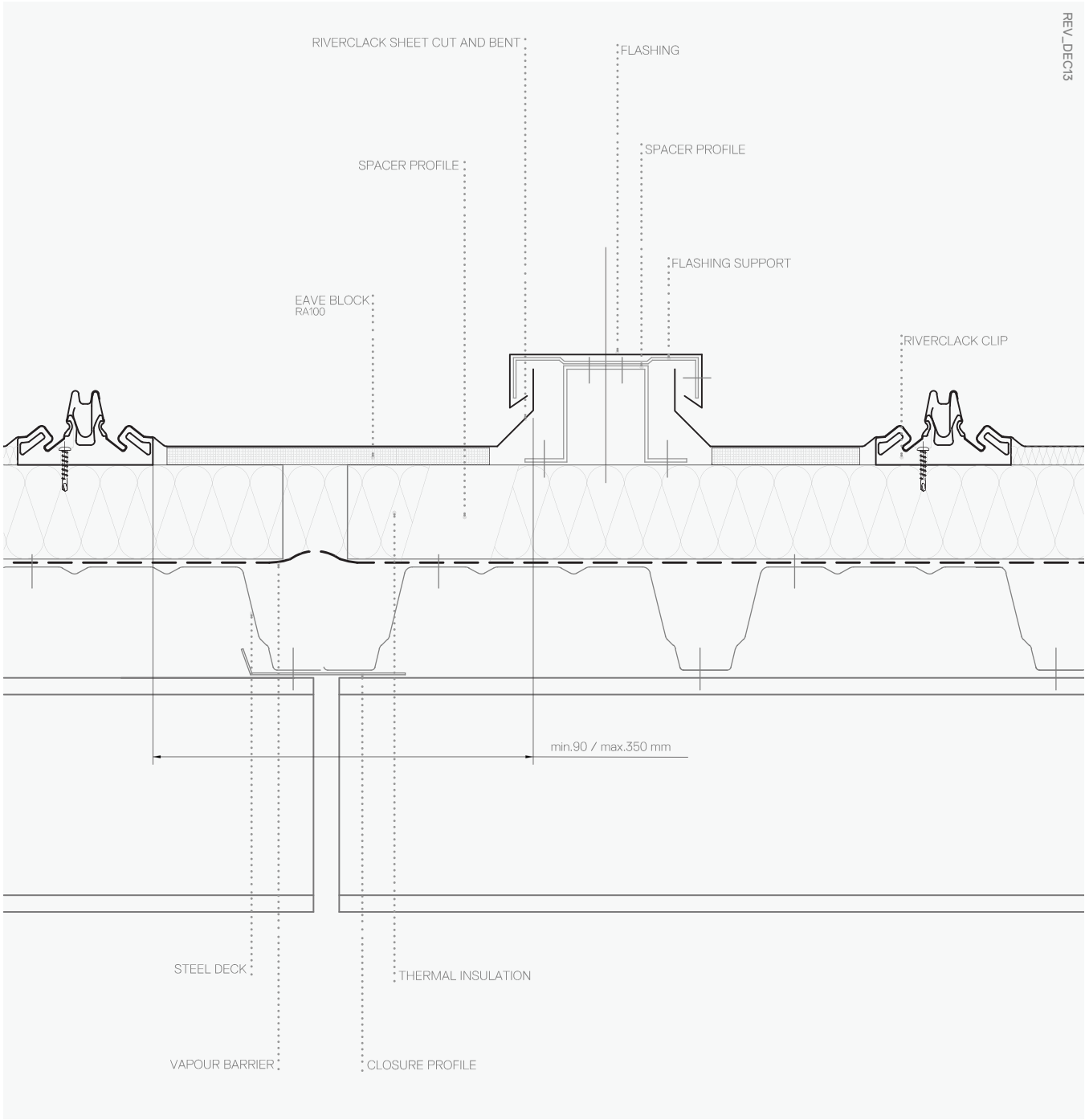

NOTES

- Expansion joint has to be calculated according to actual thermal movement

For further enquiries please contact Iscom's technical department or your local representative.

WWW.RIVERCLACK.COM

EXPANSION JOINT

STEEL STRUCTURE

DETAIL 05.02.S

TECHNICAL SITUATION / SCALE 1:5

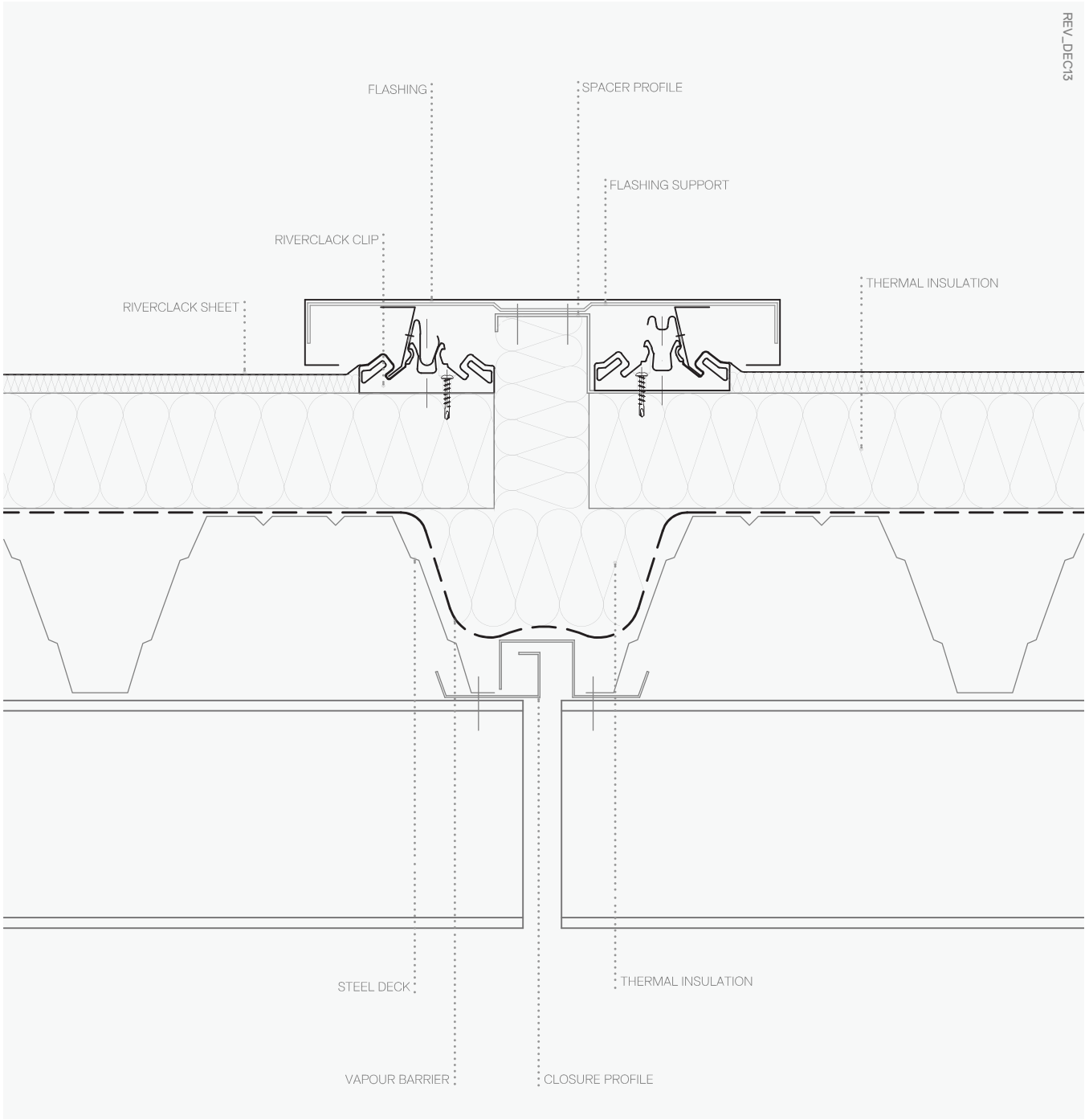

NOTES

- Expansion joint has to be calculated according to actual thermal movement

For further enquiries please contact Iscom's technical department or your local representative.

WWW.RIVERCLACK.COM

PIPE PENETRATION
STEEL STRUCTURE

DETAIL 06.01.S

TECHNICAL SITUATION / SCALE 1:5

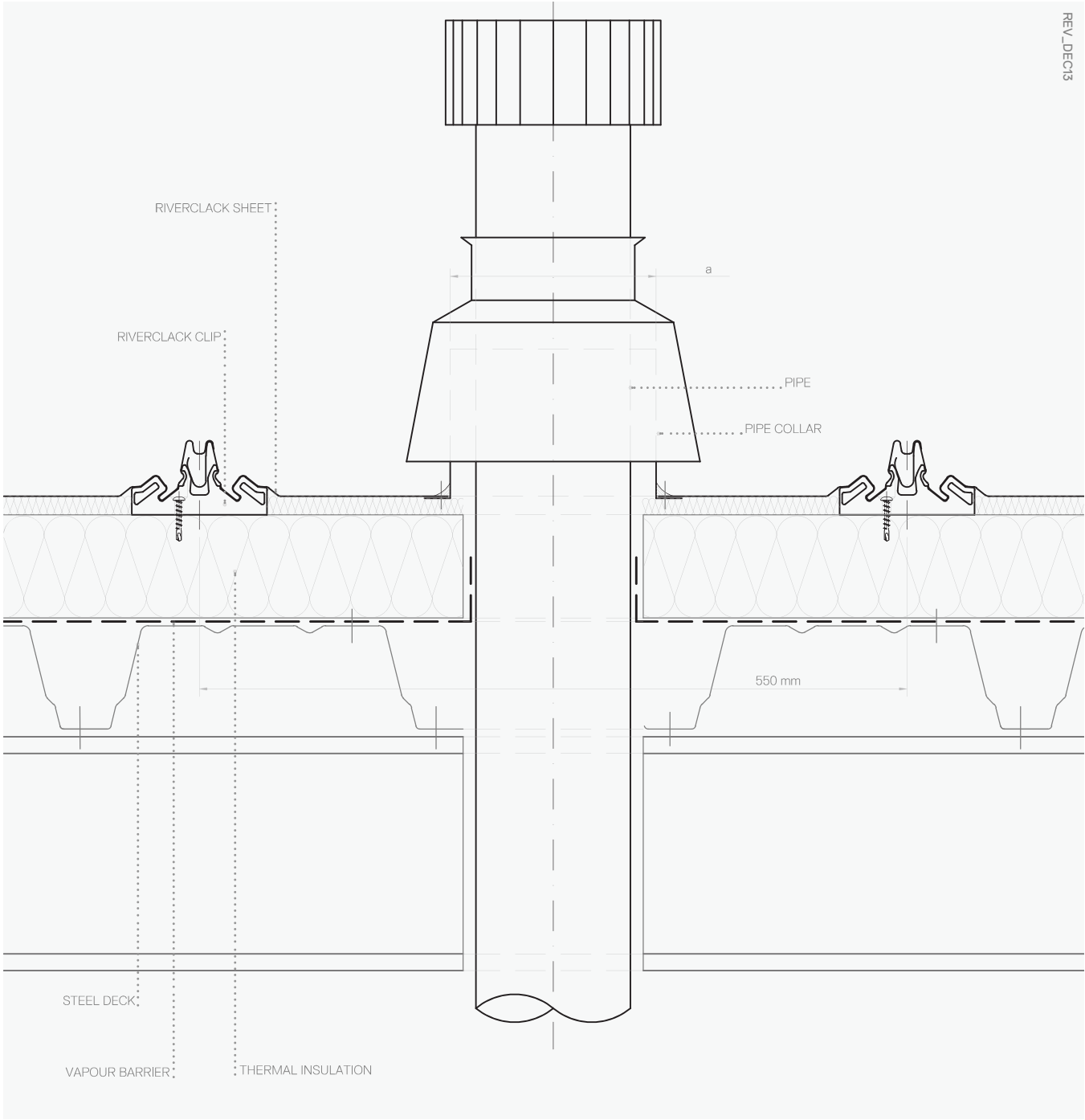

NOTES

- Dimension "a" has to be calculated according to actual thermal movement

For further enquiries please contact Iscom's technical department or your local representative.

WWW.RIVERCLACK.COM

RIDGE SKYLIGHT
STEEL STRUCTURE

DETAIL 07.01.S_AA

TECHNICAL SITUATION / SCALE 1:5

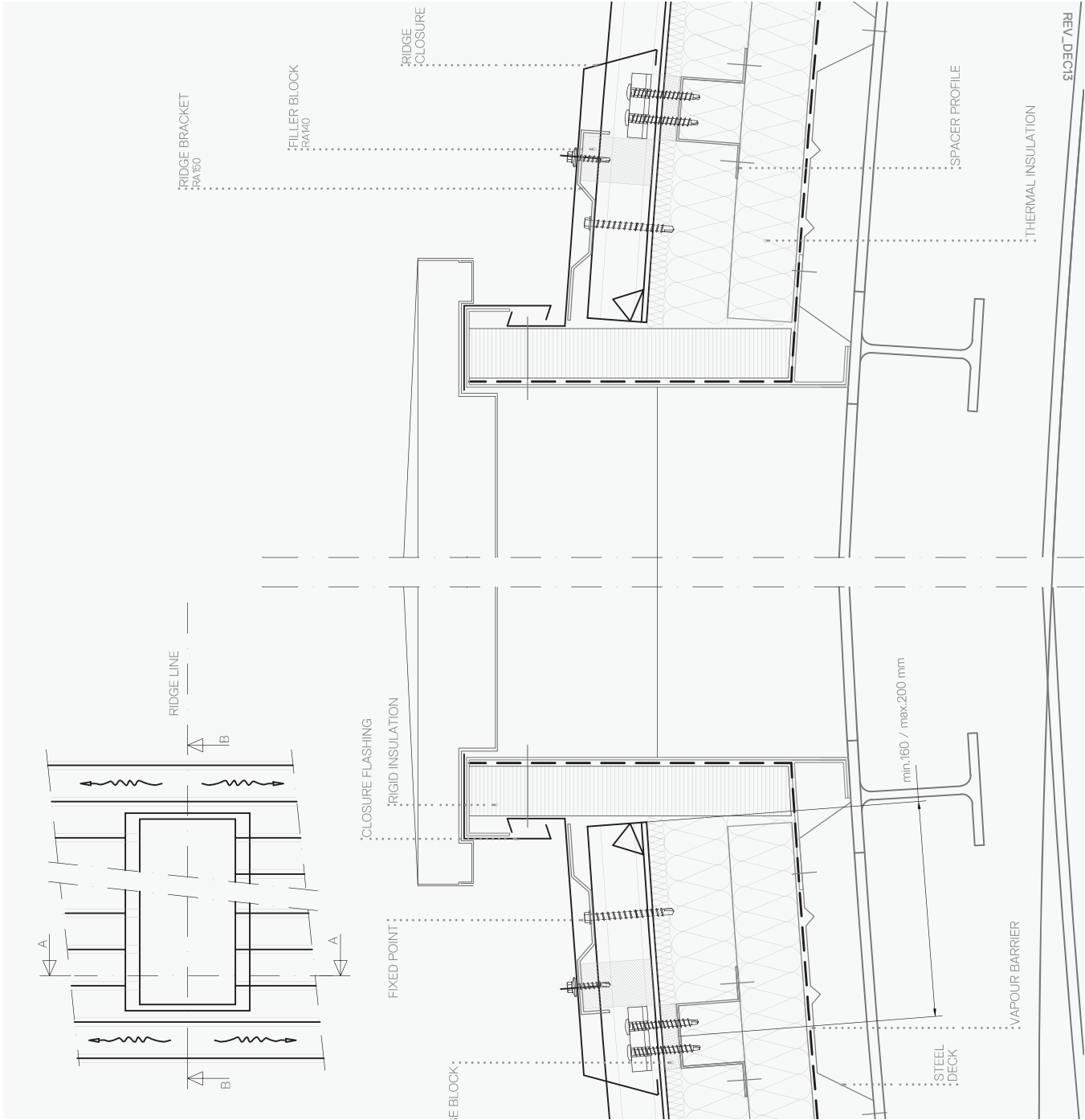

- NOTES
- Slope >6%
 - If slope <6% please use relevant detail
 - Mono ridge type considered on this sheet is one of the available options. Please consider proper type according to actual slope.

For further enquiries please contact Iscom's technical department or your local representative.

WWW.RIVERCLACK.COM

RIDGE SKYLIGHT
STEEL STRUCTURE

DETAIL 07.01.S_BB

TECHNICAL SITUATION / SCALE 1:5

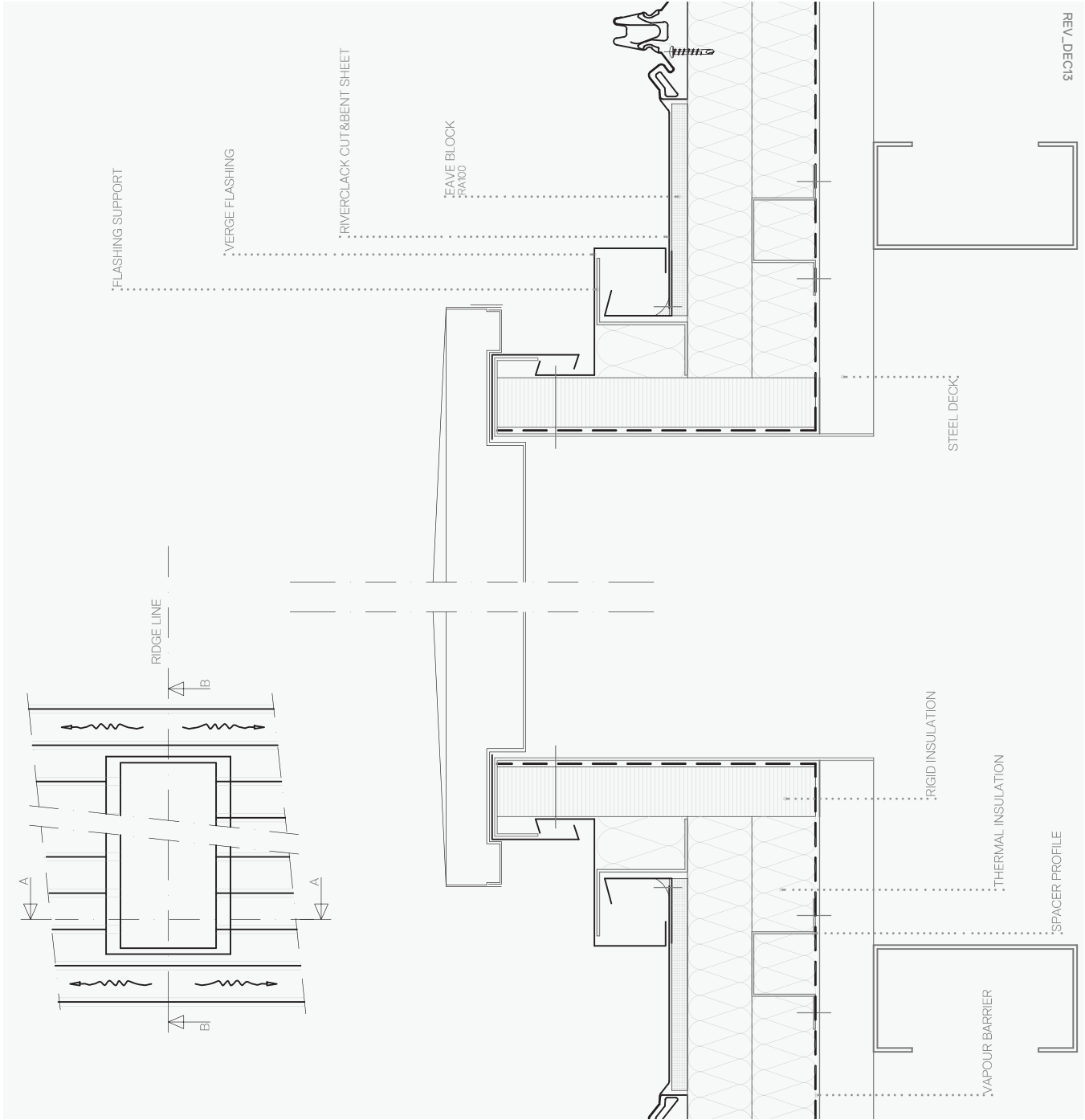

NOTES

- Verge type is just one of the possible options. Please see in chapter 03 for alternatives

For further enquiries please contact Iscom's technical department or your local representative.

WWW.RIVERCLACK.COM

WELDED ROOFLIGHT
STEEL STRUCTURE

DETAIL 07.02.S_AA

TECHNICAL SITUATION / SCALE 1:5

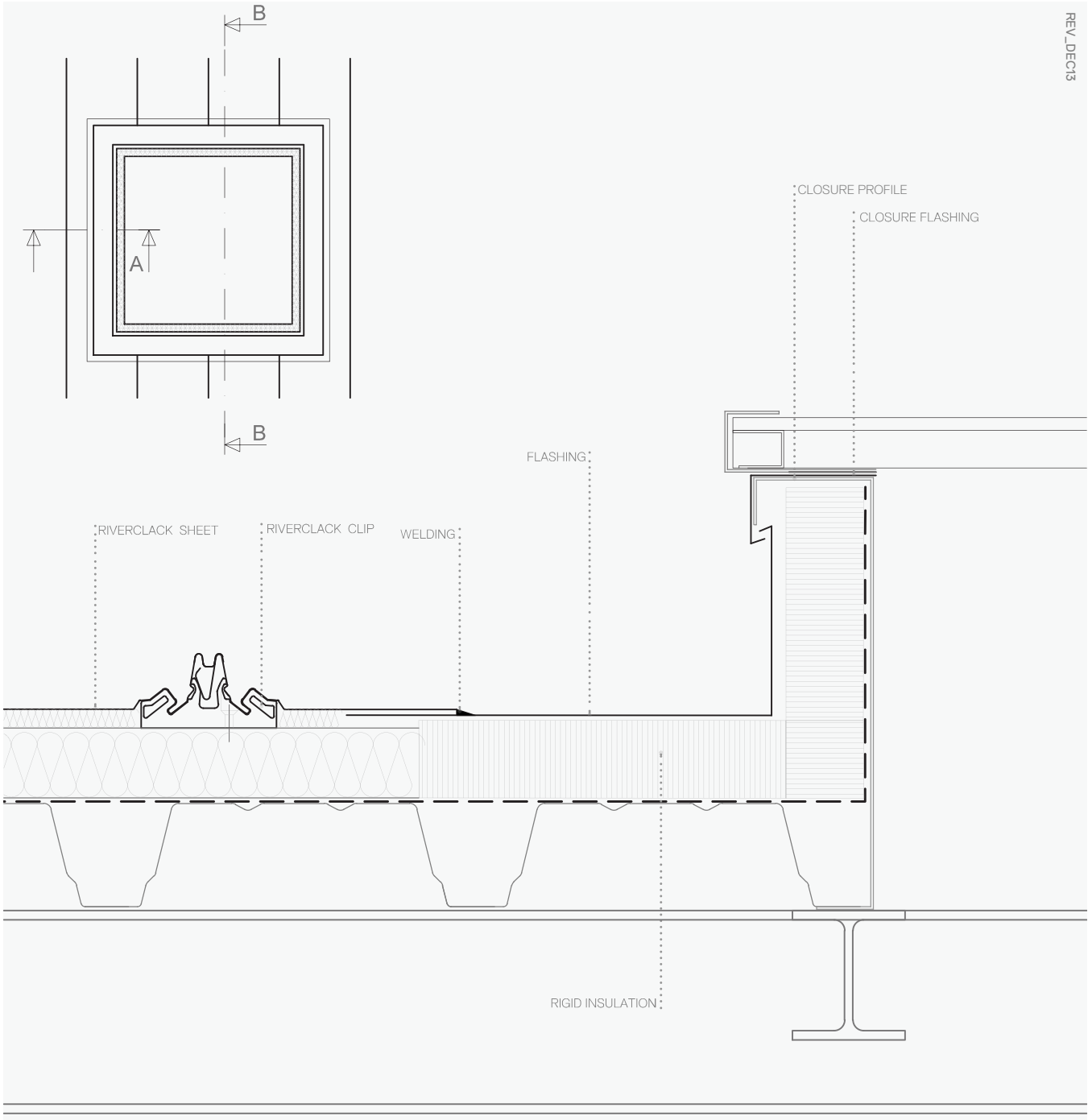

NOTES

For further enquiries please contact Iscom's technical department
or your local representative.
WWW.RIVERCLACK.COM

WELDED ROOFLIGHT
STEEL STRUCTURE

DETAIL 07.02.S_BB

TECHNICAL SITUATION / SCALE 1:5

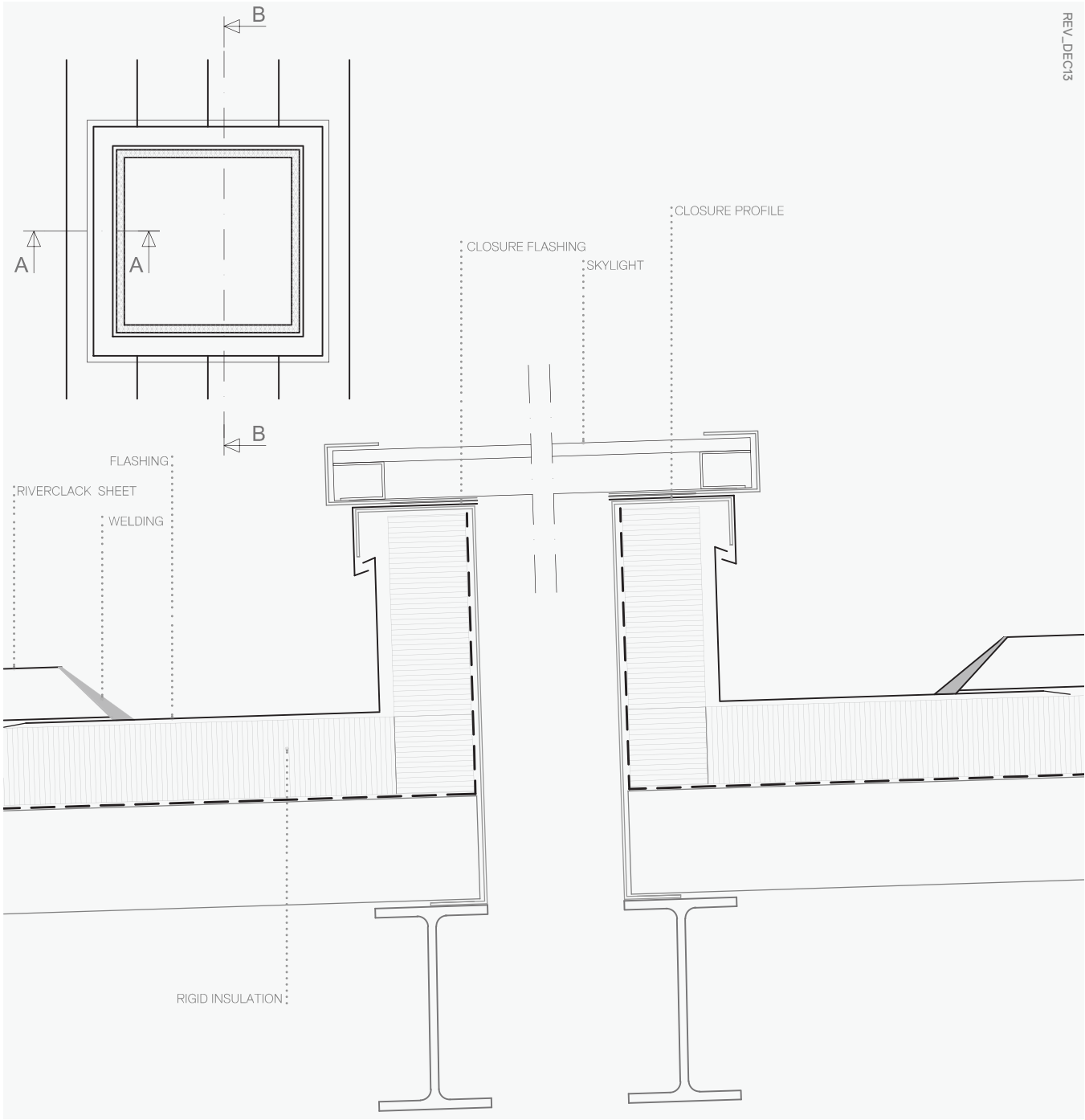

NOTES

For further enquiries please contact Iscom's technical department or your local representative.

WWW.RIVERCLACK.COM

OVERLAP DETAIL
STEEL STRUCTURE

DETAIL 08.01.S

TECHNICAL SITUATION / SCALE 1:5

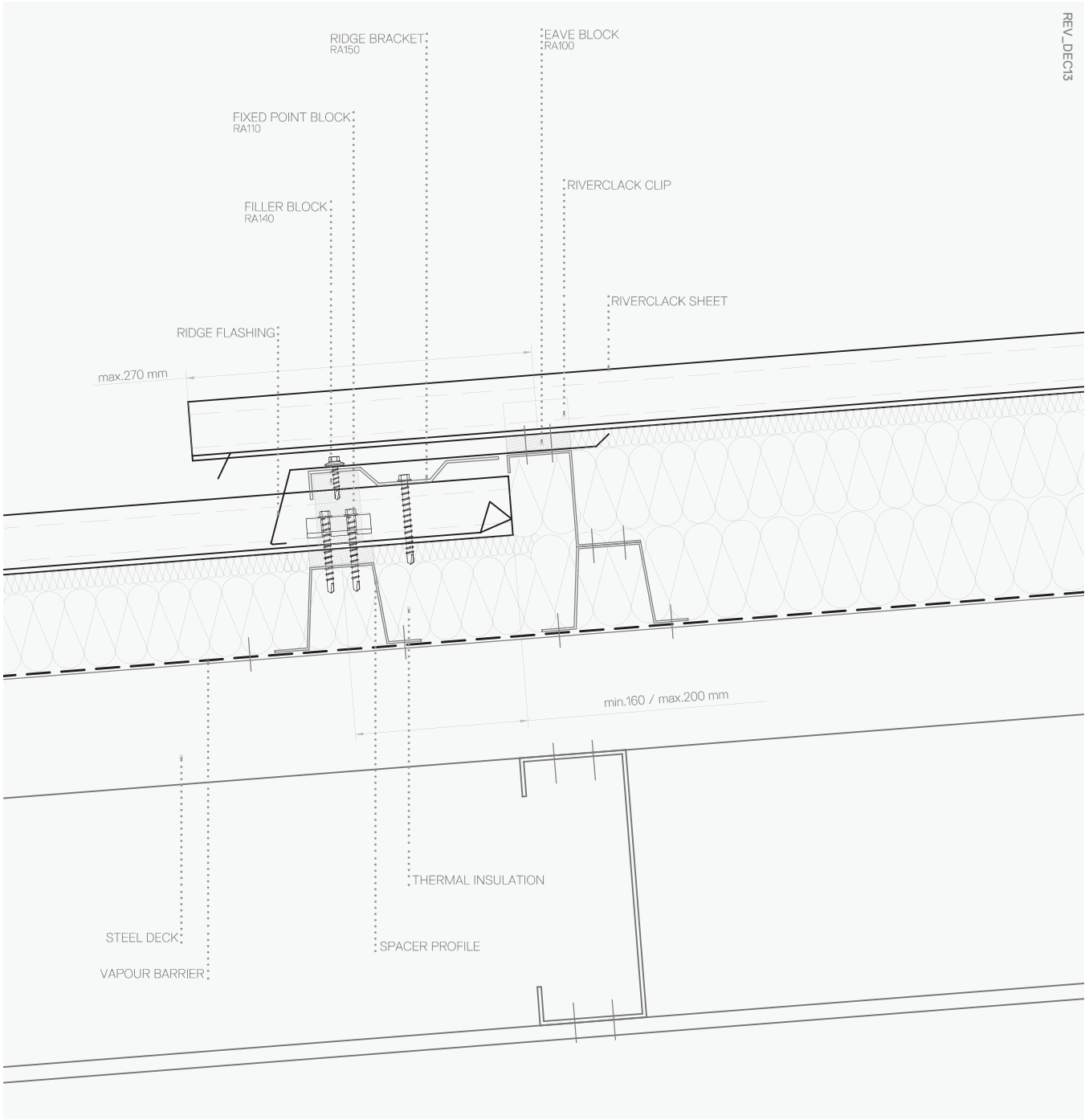

NOTES

- Walkability is not allowed on overlapping areas
- Mono ridge considered on this sheet is one of the available options. Please consider proper type according actual slope.

For further enquiries please contact Iscom's technical department or your local representative.

WWW.RIVERCLACK.COM

OVERLAP DETAIL
STEEL STRUCTURE

DETAIL 08.02.S

TECHNICAL SITUATION / SCALE 1:5

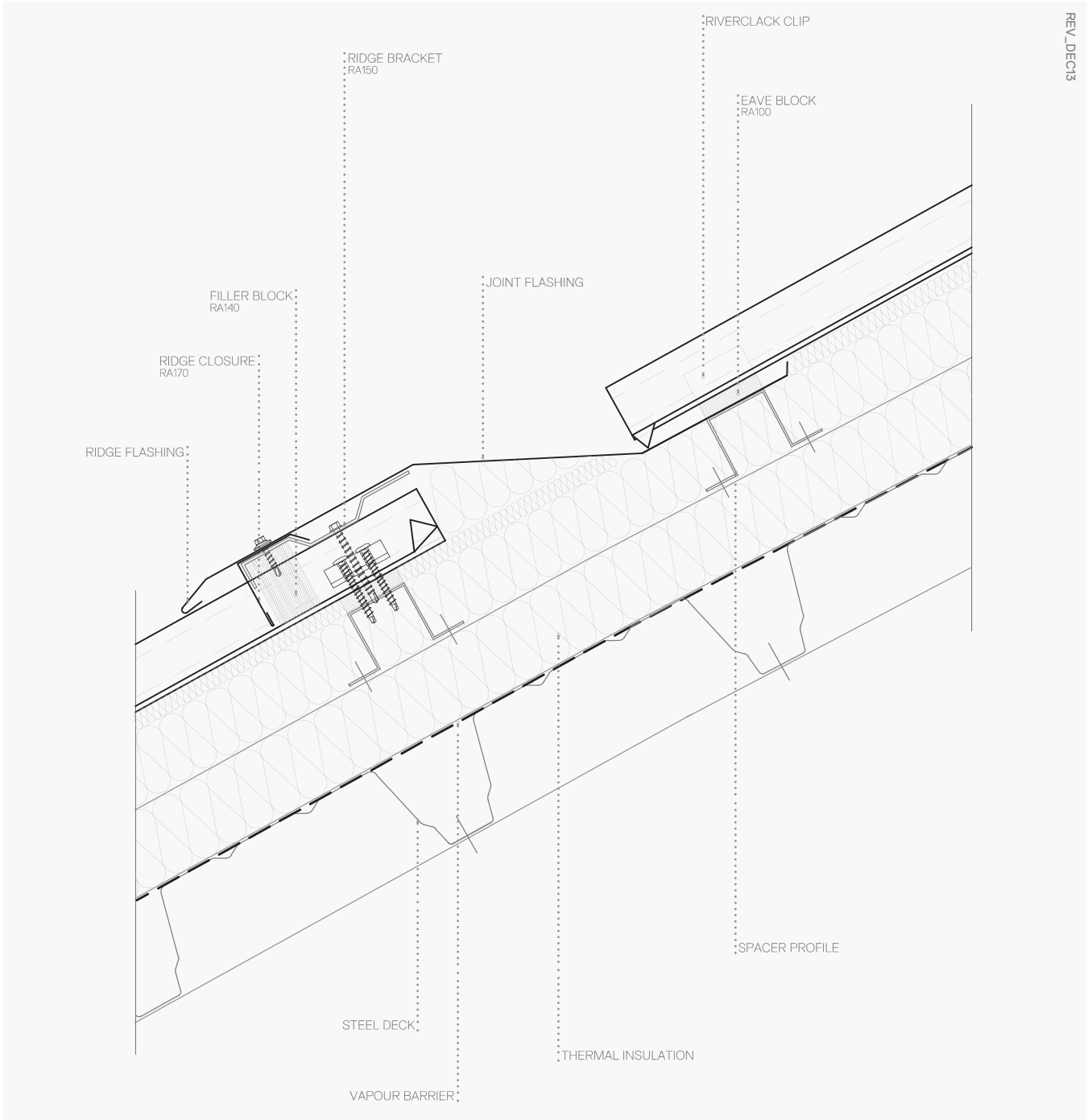

REV_DEC13

NOTES

For further enquiries please contact Iscom's technical department or your local representative.

WWW.RIVERCLACK.COM

CURVED ROOF RIDGE

DETAIL 09.01.S

TECHNICAL SITUATION / SCALE 1:5

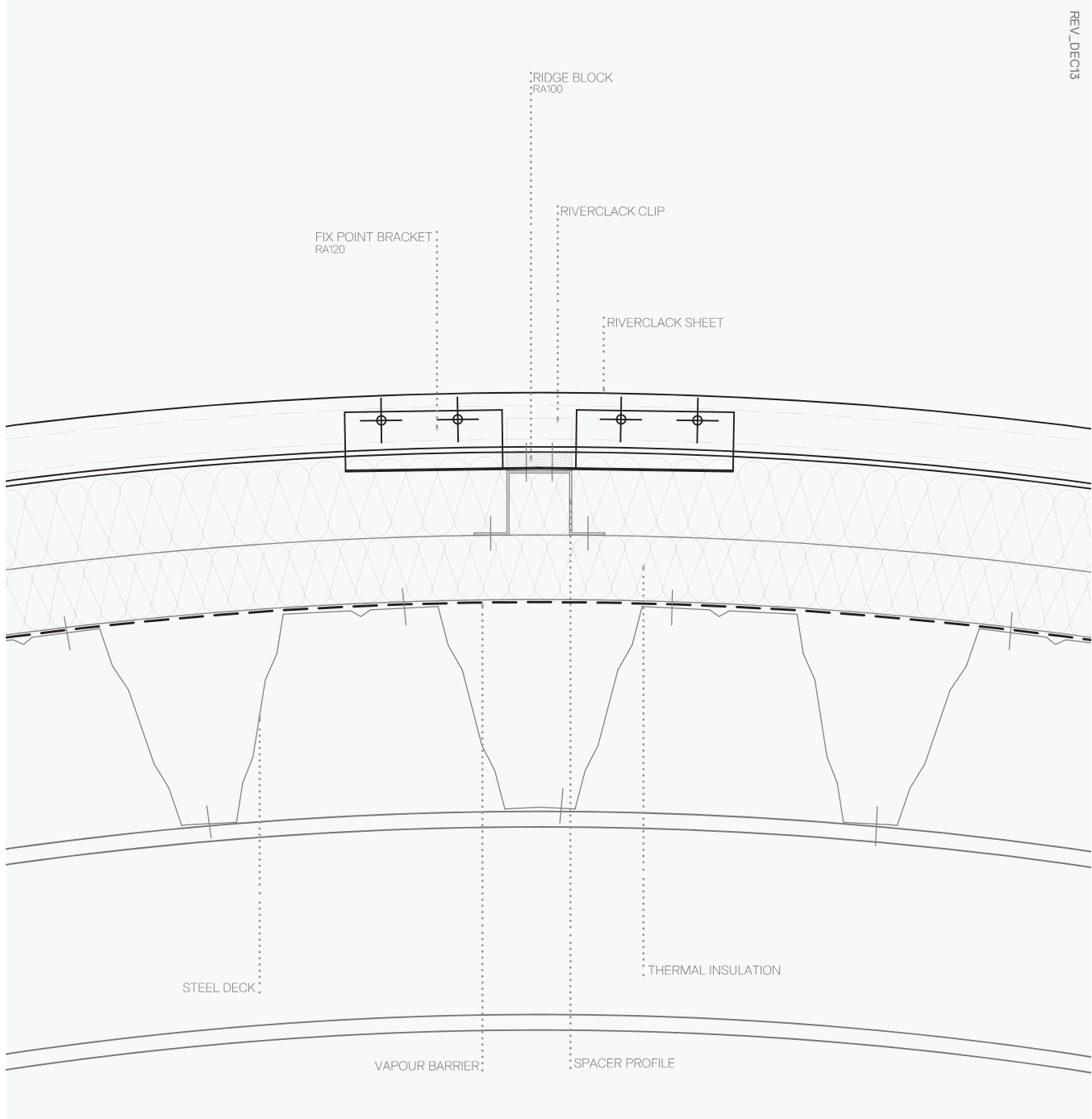

NOTES

WWW.RIVERCLACK.COM

EN

ISCOM SPA
VIA BELVEDERE, 78
37026 PESCANTINA
ITALY

WWW.ISCOM.IT
INFO@ISCOM.IT
T +39 045 773 21 77
F +39 045 773 29 70

